

- OPERATING TEMPERATURE: -55° C TO 105° C.
- MATERIAL: HOUSING, NYLON 6/6, UL 94V-0, BLACK CONTACT, 0.30 [.012] THICK COPPER ALLOY
- FINISH: BRIGHT TIN-LEAD PLATE 0.00203-0.00508 [.000080-.000200"] THICK OR MATTE WHISKER MITIGATED TIN 0.00203 [.000080] MIN THICKNESS OVER NICKEL UNDERPLATE.
- LUBRICATED WITH AMP ANTI-FRETTING LUBRICANT.
- IDENTIFICATION NUMBER FOR FIRST CIRCUIT.
- WIRE GAUGE IDENTIFICATION
- DIMENSIONS IN BRACKETS ARE IN INCHES.
- CONTACT MUST ACCEPT 1.14±0.03 [.045±.001] SQUARE POST AND REMAINED LOCKED IN POSITION.

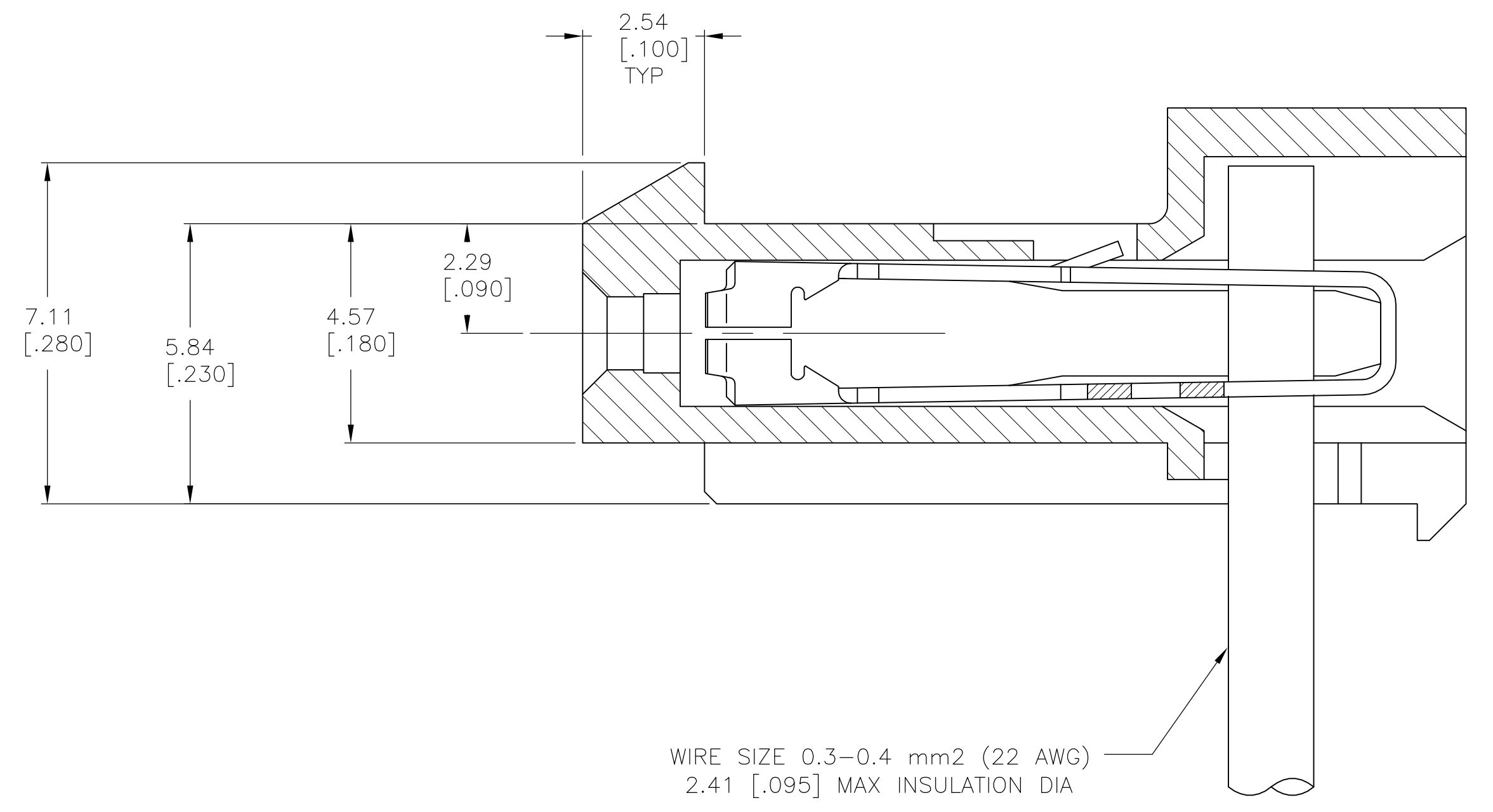

TIN	47.55±0.30	[1.872±.012]	12	4-644371-2
TIN	43.59±0.30	[1.716±.012]	11	4-644371-1
TIN	39.62±0.30	[1.560±.012]	10	4-644371-0
TIN	35.66±0.30	[1.404±.012]	9	3-644371-9
TIN	31.70±0.30	[1.248±.012]	8	3-644371-8
TIN	27.74±0.30	[1.092±.012]	7	3-644371-7
TIN	23.77±0.30	[.936±.012]	6	3-644371-6
TIN	19.81±0.30	[.780±.012]	5	3-644371-5
TIN	15.85±0.15	[.624±.006]	4	3-644371-4
TIN	11.89±0.15	[.468±.006]	3	3-644371-3
TIN	7.92±0.15	[.312±.006]	2	3-644371-2
FINISH	A		NO OF CKTS	PART NO

TIN-LEAD	47.55±0.30	[1.872±.012]	12	1-644371-2
TIN-LEAD	43.59±0.30	[1.716±.012]	11	1-644371-1
TIN-LEAD	39.62±0.30	[1.560±.012]	10	1-644371-0
TIN-LEAD	35.66±0.30	[1.404±.012]	9	644371-9
TIN-LEAD	31.70±0.30	[1.248±.012]	8	644371-8
TIN-LEAD	27.74±0.30	[1.092±.012]	7	644371-7
TIN-LEAD	23.77±0.30	[.936±.012]	6	644371-6
TIN-LEAD	19.81±0.30	[.780±.012]	5	644371-5
TIN-LEAD	15.85±0.15	[.624±.006]	4	644371-4
TIN-LEAD	11.89±0.15	[.468±.006]	3	644371-3
TIN-LEAD	7.92±0.15	[.312±.006]	2	644371-2
FINISH	A		NO OF CKTS	PART NO

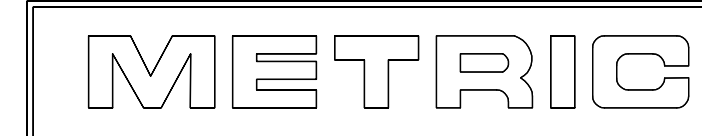

THIS DRAWING IS A CONTROLLED DOCUMENT.

DIMENSIONS: mm [INCHES]	TOLERANCES UNLESS OTHERWISE SPECIFIED:	0 PLC ± -	1 PLC ± -	2 PLC ± -	3 PLC ± 0.13[.005]	4 PLC ± -	ANGLES ± -
-------------------------	--	-----------	-----------	-----------	--------------------	-----------	------------

DIN C. MARTIN 23APR90	APVD G. MILLER 24APR90	NAME	RESTRICTED TO
CHK R. SWING 23APR90		MTA-156 CONNECTOR ASSEMBLY, QUAD, 22 AWG, WITH LOCKING RAMP	
		108-1219	
		114-1048	
MATERIAL	FINISH	WEIGHT	SCALE 10:1
		A1 00779	SHEET 1 OF 1
		C=644371	REV D

CUSTOMER DRAWING